

VIP Vision Solar Series 4.0MP 4G Bullet Camera

VSIPSLR-A41 Quick Start Guide

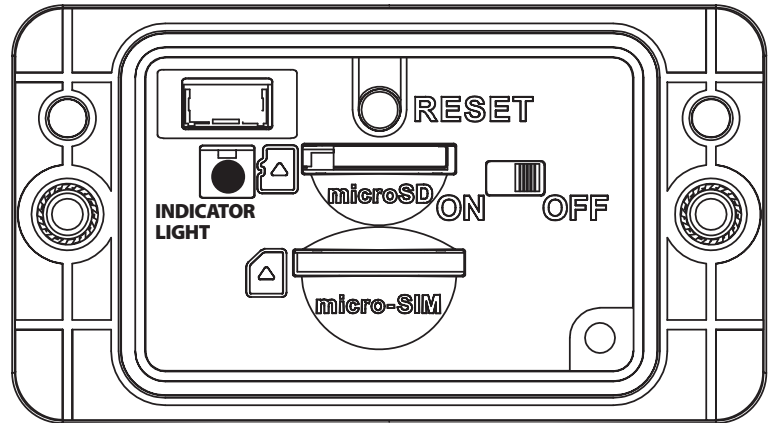

MicroSD: Insert
Contacts Up



MicroSIM: Insert
Contacts Down

Installation Information

- The camera will come with a small amount of charge. If the camera has gone flat from storage, connect the camera with a Micro USB cable and 5V 2A charger for a minimum of 2 hours (not included) or place the camera in the sun.
- This camera needs to be positioned in a location that the solar panel will receive 4-5 hours of sunlight per day to function correctly.
- When installing the camera, be sure to waterproof all cable connections to ensure water will not damage the camera cabling.
- See the above diagram as a reference during the configuration of your VSIPSLR-A41, taking note of the indicator light.

During installation, check **indicator light**, located behind the flap, on the bottom of the camera:

- **Constant green:** successful network connection
- **Flashing green:** no network connection
- **Constant red:** Booting or device is abnormal
- **No light:** Camera is sleeping or without power

This package includes:

- 1 x Solar camera with 2 x 4G antennas
- 1 x Allen key, mounting bracket & bolts
- 1 x Waterproof RJ45 boot

Required components not included in this package are a **4G microSIM card** and **microSD card (up to 256GB)** for footage recording/storage.

Further Information

- This guide covers the basic steps to get the camera connected to the mobile application and mounted correctly.
- Further information can be found by scanning the QR code on this page or by visiting <https://help.c5k.info/VSIPSLR-A41>
- We strongly recommend visiting our knowledge base for configuration assistance and troubleshooting.



VIP Vision Solar Series 4.0MP 4G Bullet Camera

VSIPSLR-A41 Quick Start Guide



It is strongly recommended to configure the camera first before mounting it to the install location.

1. Download the "DMSS" application on your iOS (Apple) or Android (Google) smart device.
1. Install the two included 4G antennas and mount the included bracket to the camera.
2. Undo the screws on the camera base to open the flap and reveal the card inputs. Orient the camera so the text & input layout matches the diagram on the previous page of this guide.
3. Install the microSD card with its card contacts facing up toward the reset button and the card notch to the left of the camera. (see diagram)
4. Install the microSIM card with its SIM contacts facing down and the notch to the left of the camera. (see diagram)
5. Set the power switch to the ON position. After boot-up (max. 120s), check that the light is a constant green, indicating that the camera is powered up and connected via 4G.
6. Open the DMSS app. Log in or create a new account (Fig. 1). After logging in, click the "+", then "SN/Scan" (Fig. 2). You must be logged in.
7. Scan the QR code on the sticker on the base of the camera to add it to your account. Wait for up to 60s for the camera to connect. If the camera fails to connect, press and hold the reset button for 30s and restart this step.
8. On connecting, you will be prompted to set the time zone and daylight saving time (if applicable). After this has been done, select "Done". Live video from the camera should now be displayed.
9. With a successful connection to the camera, you can close the flap, fastening the screws.
10. Mount the camera to your install location using the provided screws. The location must have 4~5 hours of sunlight daily and be mounted at a height of 2m to 3m from the ground for optimal infrared motion detection (PIR).
11. Adjust the camera angle whilst using the DMSS mobile application to view the live image as you adjust the camera.
12. Waterproof all cable connections, included is a waterproof RJ45 boot.
13. Adjust the solar panel angle to capture as much light as possible, ensure there is some tilt on the panel to prevent the accumulation of dust and debris.
14. It is recommended to change the password on the camera, please see the "Further Information" section for more information; visit <https://help.c5k.info/VSIPSLR-A41>

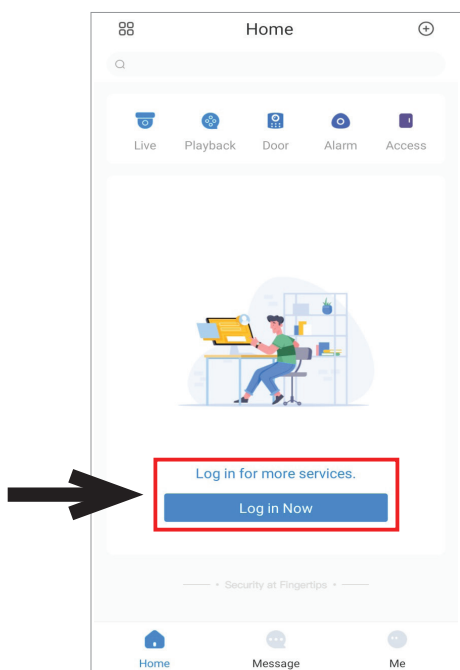

Fig. 1

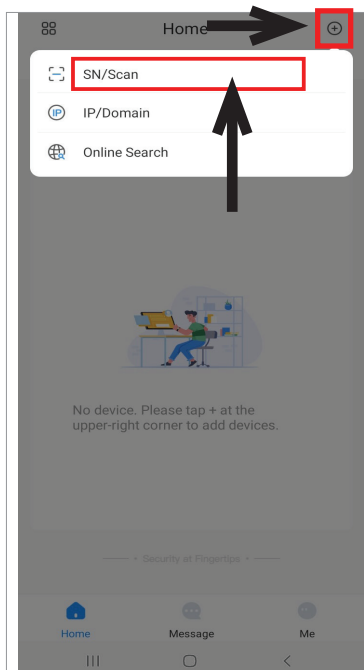

Fig. 2

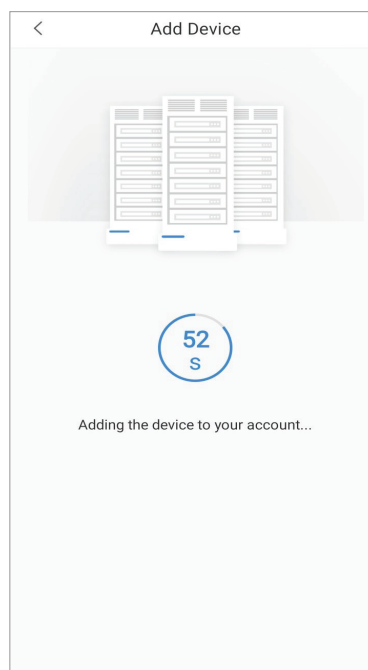

Fig. 3